

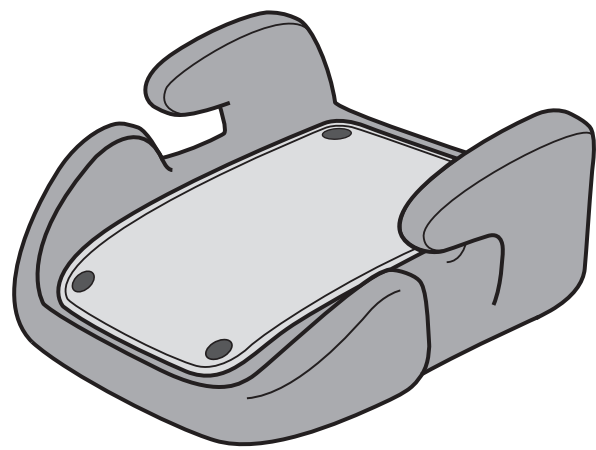

kiddicare

booster seat

Group 2-3 car seat



IMPORTANT:
KEEP FOR FUTURE REFERENCE,
READ CAREFULLY

FC2231

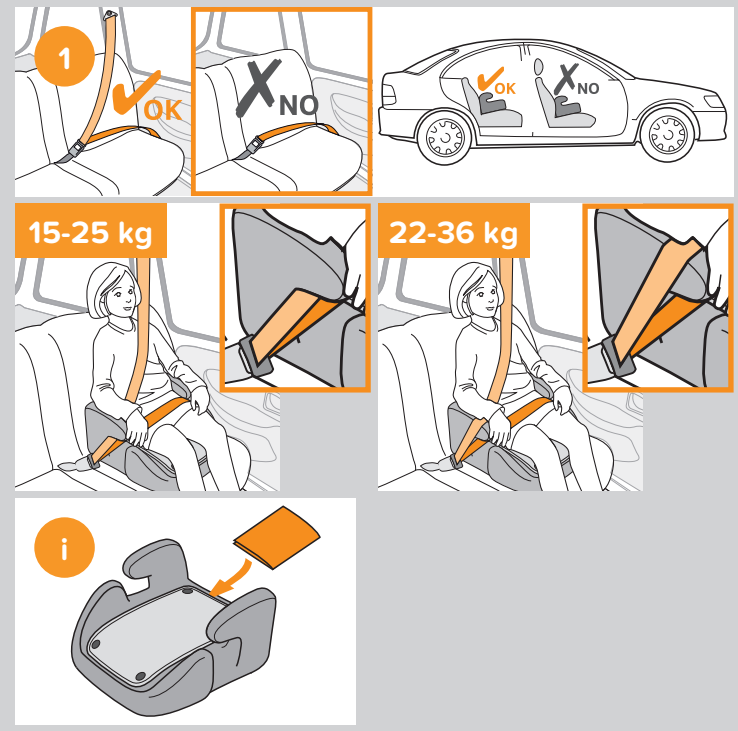

Safety

⚠ THESE INSTRUCTIONS MUST BE READ CAREFULLY BEFORE INSTALLATION. FITTING THE SEAT INCORRECTLY CAN PUT YOUR CHILD AT RISK. Only install your group 2-3 booster seat on a forward facing seat that has a 3-point seat belt (1).

The hard items and the items in plastic of the child restraint system must be located and installed so that when used normally, they do not get trapped under a movable seat or in the vehicle door. Make sure the straps to attach the restraint system to the vehicle are kept tight and adjust the straps that hold in the child. The straps must not be twisted. Make sure the sub-abdominal straps are run as low as possible, to keep the pelvis in good position. Replace the restraint system if it has been subjected to violent shocks in an accident. It is dangerous to change or add elements to the restraint system in any way without the authorisation of the competent authority, or not to carefully follow the instructions on installation provided by the manufacturer of the child restraint system. Keep the seat out of direct sunlight so that the child does not get burned. Do not leave the child unattended in a child restraint system. Make sure that luggage and other items that might harm the child in the seat in the event of a shock are correctly stowed away. Do not use the child restraint system without the cover. Do not replace the seat cover with one that has not been recommended by the manufacturer, because it plays a direct role ensuring that the restraint system works effectively. If you have a doubt concerning the installation and correct usage of your seat, please contact the manufacturer of the child restraint system. Install your child restraint system on seats categorised as “Universal” in your car manual. Do not use weight-bearing contact points other than those described in the instructions and indicated on the restraint system. Always use the back seat if possible even if the Highway Code stipulates that using the front seat is allowed. Always ensure that the seat belt has been fastened. Do not clothe the child in garments that are too bulky in winter.

WARNING

- This car seat is a “Universal” child restraint system. It has been approved in accordance with regulation N°44/04, and is suitable for general use in vehicles and is compatible with the majority (some exceptions) of vehicle seats.
- It is more likely that the seat is perfectly compatible if the vehicle manufacturer states that its vehicles are suitable for taking “Universal” child restraint systems.
- This restraint system is classified as “Universal” in accordance with the strictest approval criteria, whereas earlier models do not correspond to these new provisions.
- It can only be adapted to vehicles with 3-point safety belts that are either fixed or have a roller mechanism and that have been approved compliant with the UN/ECE N° 16 or other equivalent standards.
- If in doubt, contact the manufacturer or retailer of the restraint system.

In use

This booster seat has been designed to be used with the 3 points safety belt of the rear seat of the car. Place the booster seat on the rear of the car. The lap section of the belt should be routed **below** the armrests. The diagonal section passes **over** the child's shoulder, **underneath** the armrest for **Group 2 (children 15-25 kg)**, and **above** the armrest for **Group 3 (children 22-36 kg)**. **Make sure that the vehicle belt is properly tightened and that it is not twisted.**

Storage of the instruction manual

See (i)

Maintenance

Do not use this product if any part is broken, torn or missing and use only spares provided by the manufacturer.

Cleaning

All the material parts can be removed. Slight stains can be removed using a damp sponge soaked in soapy water or it can be washed by hand at 30° in soapy water. Do not use bleach, do not iron, do not machine wash, and do not tumble dry.

Kiddicare
Club Way,
Cygnet Park,
Hampton
Peterborough,
Cambridgeshire PE7 8JA

Customer Care: hello@kiddicare.com