

Type D9
Type F16

012

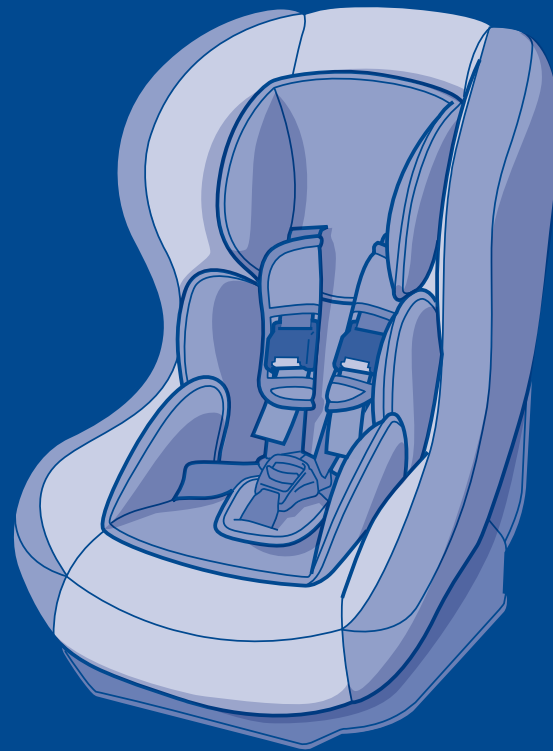

FC39GB

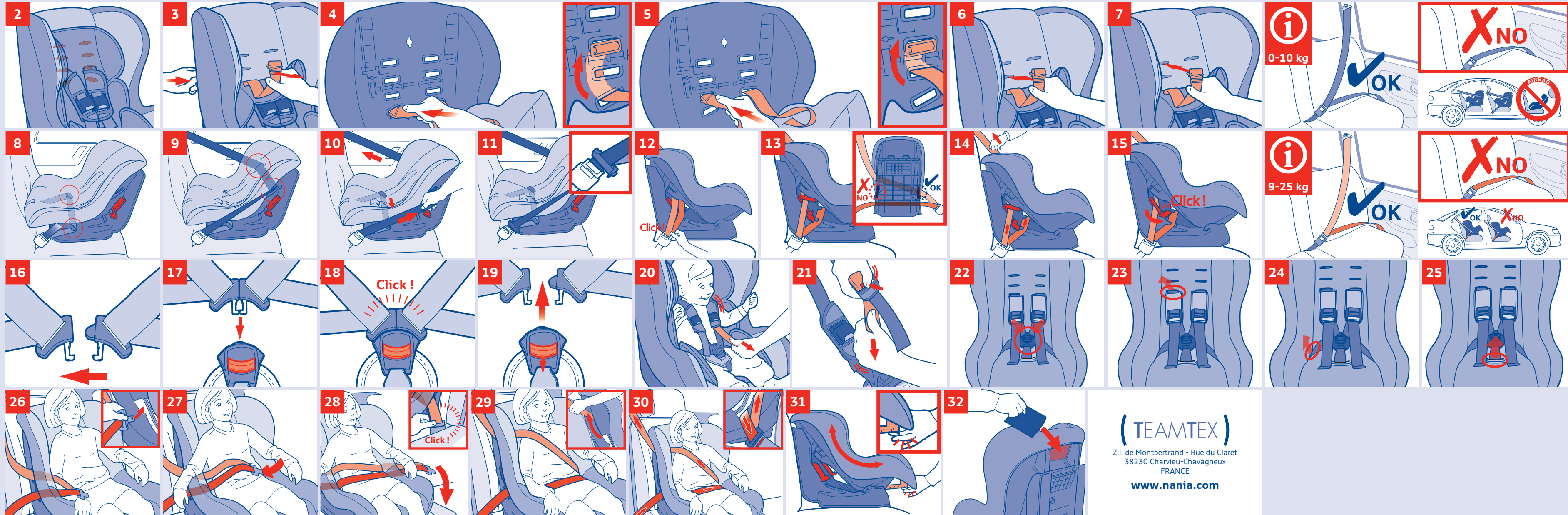

Thank you for purchasing this **Group 0-1-2 car seat**. If you require assistance with this product or if you wish to change an accessory, please contact our **customer service department**.

SAFETY INSTRUCTIONS

PLEASE READ THESE INSTRUCTIONS CAREFULLY BEFORE BEGINNING THE INSTALLATION. IF THE SEAT IS NOT INSTALLED CORRECTLY, YOUR CHILD'S SAFETY MAY BE AT RISK. DO NOT USE THIS CHILD SEAT ON A PASSENGER SEAT FITTED WITH AN AIR BAG! The seat may be installed in a front-facing or rear-facing position with a 3-point safety belt to UN/ECE No.16 standard or equivalent. Do not use it on side-facing or rear-facing seats. Always remember to fasten and correctly adjust the child's harness and never start the car without first checking that the seat is properly fixed to the passenger seat as shown in these instructions. Do not use weight-bearing contact points other than those described in the instructions and indicated on the restraint system. It is important to check that the straps of the seat belt are fully tightened and that the harness lap strap is positioned as low as possible to support your child's pelvis. Check that the seat belt and harness straps are not twisted. For maximum protection, there must be no slack between the car seat and the passenger seat. Please refer to the method recommended in these instructions. The seat must not be modified in any way and no elements should be added. It is recommended that you replace this car seat if it has been subjected to a severe impact following an accident or in case of wear. You should regularly check that the harness is not showing signs of wear, check in particular the harness points, the seams and the adjustment devices. Never leave your child unattended in the seat. Check that no part of the seat is trapped in the door or in a fold-down passenger seat. If your car has a fold-down rear seat, check that it is correctly locked in the vertical position. Direct exposure to the sun increases the temperature inside vehicles. For this reason, you are advised to cover the child's car seat when not in use in order to prevent the elements, in particular the fixations, from getting hot and burning the child. Do not use your car seat without its cover and only replace it with a cover that has been recommended by the manufacturer. In an emergency, the child must be able to be freed quickly. The buckle, which can be easily opened, must therefore not be covered. Teach your child not to play with the buckle. Always remember to check that there are no scraps of food or other remains in either the harness buckle or the central adjuster. Luggage and other heavy or sharp objects must be fixed down in the car. Objects that are not attached may injure a child in the event of an accident. In winter, make sure that the child is not wearing over-bulky clothes.

Your Group 0-1-2 car seat (1)
This seat is classified as group 0-1-2 for children from 0 to 25 kg.

- 1. Shell + cover
- 2. Harness + shoulder pad (x2)
- 3. Adjuster (x2)
- 4. Adjustment strap (x2)
- 5. Harness buckle
- 6. Base
- 7. Blue lock-off clip (for rearward facing use only)
- 8. Infant reducer cushion (some models only)
- 9. Pillow (some models only)
- 10. Diagonal belt guides (x2 - for rearward facing use only)
- 11. Red belt lock-off (x2 - for diagonal belt (forward facing use only)
- 12. Lap belt guides (x2 - for forward facing use only)

13. Lap belt guides (x2 - for rearward facing use only)
14. Seat reclining lock

Adjusting the harnesses

Make sure that the harness of your car seat is adapted to the height of your child before starting to install the seat in your car. The harnesses can be adjusted to 4 different heights and must be positioned as close as possible to your child's shoulders (2).

- The two lower positions are **ONLY** intended for use in group 0, for a child weighing from 0 to 10 kg in a rear-facing position. If your child's shoulders are between two levels in a rear-facing configuration, choose the lower of the two.
- The two upper positions are **ONLY** intended for use in group 1, for a child weighing from 9 to 18 kg in a front-facing position. If your child's shoulders are between two levels in front-facing configuration, choose the higher of the two.

To adjust the height of the harnesses, remove the upper section of one of the harness straps by pivoting the metal anchor located behind the back rest and then pulling it through the slots of the shell and cover (3). Repeat the operation on the upper section of the second strap.

Feed the ends of the harness straps through the slots at identical level in both the cover and the shell, according to the chosen configuration:

- For a rear-facing configuration (Gr. 0, from 0 to 10 kg), the harnesses are fed through one of the two lower positions and then up to the third position to be secured inside the shell (4) (5). Make sure that the metal anchor is correctly positioned and that the ends of the harness straps are not twisted.
- IMPORTANT:** Whichever of the two lower positions you have chosen, make sure that the metal anchors of the harnesses are well secured through the slots of the third position of the shell.

- For a front-facing position (Gr. 1, from 9 to 18 kg), the harnesses are fed through one of the two upper positions and are secured directly behind the position chosen, at the back of the shell (6) (7). Make sure that the metal anchor is correctly positioned and that the ends of the harness straps are not twisted.

The correct type of safety belt to use with your car seat

Your car seat must **ONLY** be installed on a passenger seat fitted with a 3-point safety belt. **NEVER** install your car seat on a passenger seat fitted with a 2-point safety belt (i - 0-10 kg) (i - 9-25kg)

Rearward facing use (Gr.0 // 0 - 10 kg)

DO NOT USE THIS CHILD SEAT ON A PASSENGER SEAT FITTED WITH AN AIR BAG!
When used rearward facing, the child seat must be in the fully reclined position. Pull lap and diagonal sections of the car seat belt until fully extended and feed both through the space between the shell and the base. Fasten the seat belt. Thread the lap section through the guides located at the front of the base (8). Thread the diagonal strap through the two upper guides located on the back of the seat shell (9). Tighten the seat belt by pulling first on the lap section, then on the diagonal one (10). Check that there are no kinks or twists in the seat belt. Lock the 2 sections of the belt with the blue lock-off clip. The lock-off should be positioned against the buckle of the

seat belt (11).
Do not use the red lock-off for the rearward facing installation. Always keep the seat in the most reclined position.

Forward facing use (Gr.1 // 9-18kg)

Fully recline the seat. Pull lap and diagonal sections of the car seat belt until fully extended and feed both through the space between the shell and the base. Fasten the seat belt (12). Thread the lap section through the guides located below the red lock-off clips. Open the red lock-off clip next to the buckle, then route the diagonal section of the belt through the open lock-off clip (13). **It is important that you DO NOT route the diagonal section of the belt through the red lock-off clip on the other side of the seat.** Push the child seat right down into the car seat, and tighten both sections of the seat belt by pulling the belt in the direction shown (14). Close the lock-off across the diagonal belt (15). Check that there are no kinks or twists in the seat belt.

Harness buckle

To fasten the harness, bring the two shoulder straps together (16) (17) and insert them into the buckle; you should hear a "click" (18). To release the harness, press the buckle's red button (19).

Fitting the harness

- To tighten the harness: Pull on the adjusting straps positioned on the harness. You do not need to press on the adjuster buttons (20). **IMPORTANT: A correctly adjusted harness is essential for your child's protection. There should not be more than finger's width between the harness and your child.**
- To loosen the harness: Press on the adjuster buttons positioned on the upper section of the harness, grasp the lower section and pull simultaneously (21).

Removing the harness

Put the harness connectors together and close the buckle in order to assemble the various parts of the harness and the crotch strap (22). This will enable you to store the harness more easily for future use. Remove the upper section of one of the harness straps by twisting the metal keeper located behind the backrest and then pulling the end of the harness strap through the slots of the shell and the cover (23). Repeat the operation on the second strap. Remove one of the lower section of the harness by twisting the metal keeper located under the base and then pulling the end of the harness strap through the slots of the base and the cover (24). Repeat the operation on the second lower section. Remove the crotch strap by twisting the metal keeper and by passing it through the slots in the base and the cover (25). **Simply reverse this procedure if you want to re-install the harness of your car seat.**

Forward facing use (Gr.2 // 15 à 25 kg)

Make sure that you have removed the harness of the car seat before starting the installation. Follow the instructions in the section entitled 'Removing the harness'. **The car seat must be set in its most upright position.**

Place the car seat in a front-facing position on the rear passenger seat of your vehicle and sit your child in the car seat. Pull on the seat belt until it is completely loose. Thread the seat belt through the openings on the side of the shell and cover of the car seat (26). Pull on the belt and threaded through the openings on the opposite side of the shell and cover (27). Fasten the seatbelt (28). On the side nearest the belt winder, pull up the diagonal belt through the slot located on the side of the shell (29). Make sure the belt is not twisted and pull it as tightly as possible (30). Check that the diagonal lies across your child's shoulder, clear of their neck.

Reclining your child seat

Push the adjustment lever located under the front of the seat upwards, then pull or push the base towards or away from you (31).

Storage of the instruction manual (32)

Maintenance advice

All the material parts can be removed. Slight stains can be removed using a damp sponge soaked in soapy water or it can be washed by hand at 30° in soapy water. Do not use bleach, do not iron, do not machine wash, and do not tumble dry.

WARNING

- This car seat is a "Universal" child restraint system. It has been approved in accordance with regulation N°44/04, and is suitable for general use in vehicles and is compatible with the majority (some exceptions) of vehicle seats.
- It is more likely that the seat is perfectly compatible if the vehicle manufacturer states that its vehicles are suitable for taking "Universal" child restraint systems.
- This restraint system is classified as "Universal" in accordance with the strictest approval criteria, whereas earlier models do not correspond to these new provisions.
- It can only be adapted to vehicles with 3-point safety belts that are either fixed or have a roller mechanism and that have been approved compliant with the UN/ ECE N° 16 or other equivalent standards.
- If in doubt, contact the manufacturer or retailer of the restraint system.

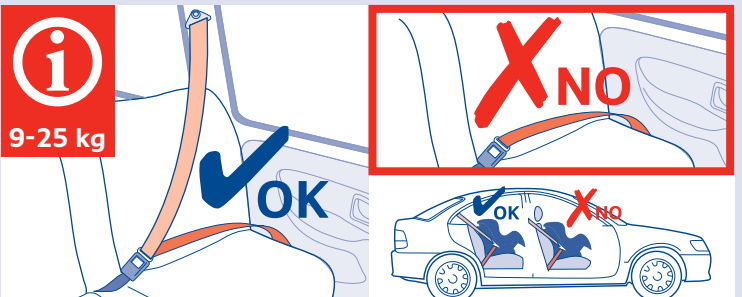
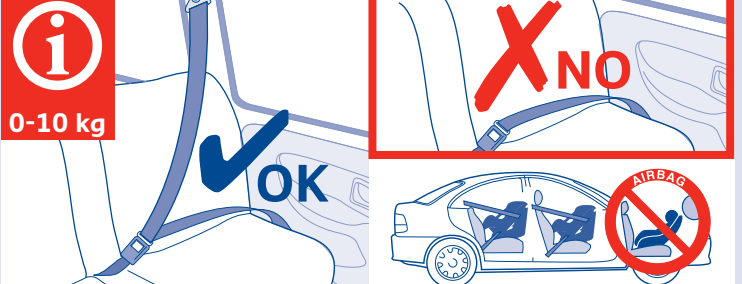

(TEAMTEX)
Z.I. de Montbertrand - Rue du Claret
38230 Charvieu-Chavagneux
FRANCE
www.nania.com