



APRAMO® ONE™ CHILD CAR SEAT

www.apramo.com



0 - 36KG

Thank you for purchasing the APRAMO® ONE™ seat, if you have any questions regarding the installation and use of this seat, or require spare parts or accessories, please contact our Customer Services Department.

Please take time to read this instruction manual and familiarise yourself with the seat before use.

CONTENTS

1. Important Information	01
2. Installation Notes	02
3. Preparing the APRAMO® ONE™ before Use	03-04
3.1 ISOFIX setup	
3.2 Harness and headrest adjustment for Group 0+, I & II	
3.3 Headrest adjustment for Group II & III	
3.4 Recline function	
3.5 360° rotation function	
4. Rearward Facing Installation	05-08
4.1 Group 0+ (0 - 13 KG approx.) with 5-point harness + ISOFIX + Top tether	
4.2 Group 0+ (0 - 13 KG approx.) with 5-point harness + vehicle belt	
5. Forward Facing Installation	08-12
5.1 Group I (9 - 18 KG approx.)	
5.1.1 With 5-point harness + ISOFIX + Top tether	
5.1.2 With 5-point harness + vehicle belt	
5.2 Group II (15 - 25 KG approx.) with 5-point harness + vehicle belt + Top tether	
5.3 Group II & III (15 - 36 KG approx.) with vehicle belt	
6. Removing the APRAMO® ONE™ from the Vehicle	13
7. Removing the 5-Point Harness	13-14
8. Installing the 5-Point Harness	14-15
9. Care and Maintenance	16
9.1 Harness buckle maintenance	
9.2 Cleaning the car seat covers	
9.3 Internal cushion of seat cover	
10. Applicable Car List	17-20

1. Important Information

1. This child seat is suitable for children up to 36KG, (Group 0+, I, II & III - from birth to approximately 12 years of age).
2. Please follow the instructions in this manual carefully, failure to follow the instructions may affect your child's safety.
3. This seat is suitable for use in vehicles fitted with a 3-point retractable safety belt approved to ECE R16 or equivalent. Can also be used with ISOFIX.
4. Never use this seat without the covers supplied. Do not replace the cover with any, other than those recommended by the manufacturer as this may affect the safe use and performance of the seat.
5. Parts of this seat may become hot in warm weather. Shade your vehicle and the car seat from sunlight to avoid causing injury to your child.
6. The car seat may incur wear and tear over several years use, if you require replacement parts, please contact our customer service department.
7. Ensure that any loose articles are secured in the vehicle as these may present a hazard in the event of an accident.
8. Ensure that the seat is installed so that, under normal vehicle usage conditions, no part can become jammed under, or between any moveable seats, or in the vehicle door.
9. Do not modify, or add to the car seat in any way without the approval of a competent authority, or the manufacturer, as this will void any warranty and may affect safety and performance.
10. Always ensure that the seat is securely fastened, even when unoccupied, a loose seat can cause injuries in the event of a collision.
11. Never leave your child unattended in the car seat.
12. Never use bleach, or other toxic cleaning fluids as these can cause illness.
13. Always replace any car seat that has been involved in an accident, however minor, as unseen damage may have occurred.
14. Do not use this car seat on a passenger seat fitted with a frontal airbag.
15. The illustrations in this manual are for reference only, and may differ slightly from your seat model.

2. Installation Notes

⚠️ WARNING	
DO NOT USE FORWARD FACING BEFORE THE CHILD'S WEIGHT EXCEEDS 9KG.	
	
GROUP 0+ (0 - 13KG APPROX.)	GROUP I, II & III (9 - 36KG APPROX.)

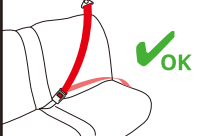
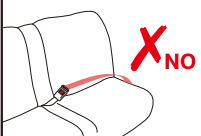
⚠️ WARNING	
NEVER USE WITH A 2-POINT LAP BELT.	
	

⚠️ WARNING	
NEVER USE ON A PASSENGER SEAT WITH A FRONTAL AIRBAG.	

⚠️ AIRBAG		
		

This seat uses two fitting methods:

ISOFIX SYSTEM AND TOP TETHER WHICH IS SUITABLE FOR GROUP 0+ & I (0 - 18KG APPROX.).

				
CLASS B1, E				

3-POINT VEHICLE BELT WHICH IS SUITABLE FOR GROUP 0+, I, II & III (0 - 36KG APPROX.).

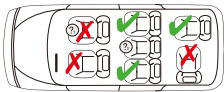
	<p>① Can not be used in the passenger seat with the airbag activated.</p> <p>② Only suitable for seats with a 3-point vehicle belt.</p>
--	---

3. Preparing the APRAMO® ONE™ before Use

3.1 ISOFIX Setup

1. If your vehicle does not have ISOFIX guide socket, please insert the guide socket (02) into the ISOFIX anchor (01). (fig. 1)

TIP: ISOFIX anchors are located between the backrest and the seat cushion of your vehicle.

2. Pull the ISOFIX strap loop (03) out as far as it will go. (fig. 2)

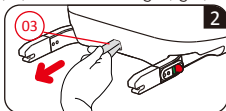
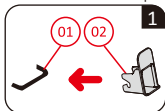

3.2 Harness and headrest adjustment for Group 0+, I & II (Group II can be used with 5-point harness)

1. Press down on the central adjuster, and pull the shoulder straps towards you (05) (Do not pull on the shoulder pads (06)), extending the 5-point harness as far as it will go. (fig. 3)

2. Pull upwards on the adjusting ring (07), whilst pulling up, or pushing down the headrest to the required position (08). The headrest (08) should be positioned so that the shoulder straps fit level with the child's shoulders. (fig. 5)

CAUTION: The shoulder straps (05) must be correctly positioned as shown in fig. 5.

Adjust the headrest (08) correctly to protect the child safely. The height of headrest (08) is to make the shoulder belts (05) to be same level with the shoulder of child. (fig. 5)

CAUTION: The shoulder belts (05) must not run behind the back of the child or at ear height or above the ears.

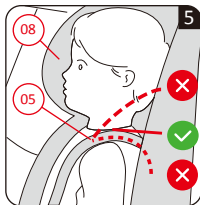
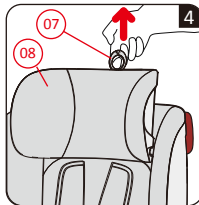
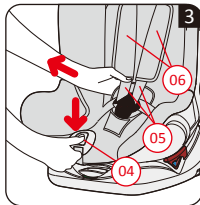

3.3 Headrest adjustment for Group II & III

- Using the release handle (09), adjust the headrest (08) up or down as required, then release the handle and the headrest will lock into place automatically. (fig. 6)
- If required, the headrest (08) can be further adjusted by using the adjusting ring (07), please refer to section 3.2 for details.
- The headrest (08) is in the correct position when the diagonal portion of the vehicle seatbelt (10) sits on the child's shoulders, a gap of about 2 fingers width between the child's shoulders and the lowest edge of the headrest. (fig. 7)

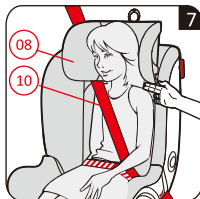
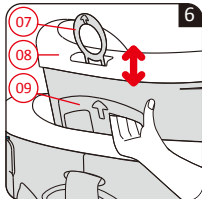

3.4 Recline function

- Using the release mechanism (11), adjust the seat (12) to the desired position then release the mechanism and the seat will lock into place automatically. (fig. 8)

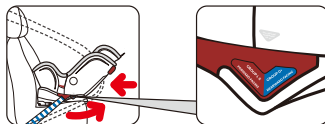

CAUTION: Please adjust the seat as fullest recline position when rearward facing is in use for the child. The fullest recline position of the seat is that the triangular sign on seat body will match with the groove on the red belt guide.

3.5 360° rotation function

- Press the release button (13) to release the seat (12), and then rotate the seat to the desired position. Release the release button (13) to lock the seat (12) into place automatically. (fig. 9)

CAUTION: The child seat can only be used in forward or rearward facing position when travelling. Always ensure that the rotating part of the child seat is fully engaged by trying to turn the seat (12) around in both directions.

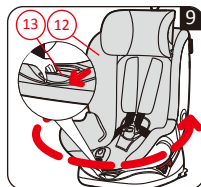
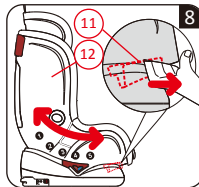

4. Rearward Facing Installation

- 4.1 Group 0+ (0 - 13 KG approx.)
with 5-point harness + ISOFIX + Top tether
- 4.1.1 Prepare the ISOFIX. (See section 3.1)
- 4.1.2 Ensure that the 5-point harness is correctly installed.
(Refer to section 8)
- 4.1.3 Ensure that the 5-point harness is correctly adjusted.
(Refer to section 3.2)
- 4.1.4 Adjust the seat to the fullest recline position (See section 3.4) and ensure that the recline mechanism is securely locked.
- 4.1.5 Rotate the seat to the rearward facing position (See section 3.5) and ensure that the rotation mechanism is securely locked.
- 4.1.6 Place the child car seat on the vehicle seat facing the rear of the vehicle against the direction of travel. (fig. 10)
- 4.1.7 Insert the ISOFIX connectors (15) into the guide socket (02) until an audible click is heard and the indicators (16) are green. (fig. 10, 11)

CAUTION: The ISOFIX connectors (15) are secured only when both indicators (16) are completely green.

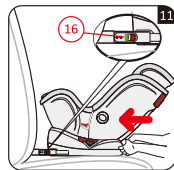
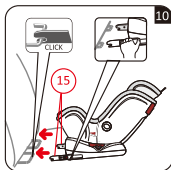

- 4.1.8 Push the seat back until it is in contact with the backrest of the vehicle seat. (fig. 12)
- 4.1.9 Depress the release button of the Top tether adjuster to release the strap. (fig. 13)

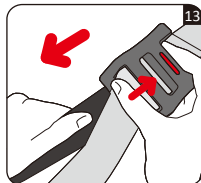
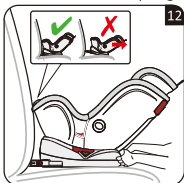

- 4.1.10 Insert the Top tether strap into the lock-off pics (17). (fig. 14)
- 4.1.11 Hook the snap hook (18) onto the Top tether anchorage point in your vehicle. To find this, look for this sign (Ⓜ) in your vehicle, or check in your vehicle handbook, or with your vehicle dealer.

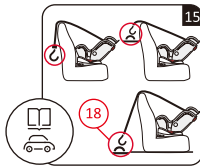
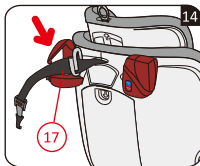

- 4.1.12 Pull on the free end of the Top tether strap until the indicator shows green. (fig. 16)
- 4.1.13 Follow the steps in section 4.1.14 to secure your child in the seat with the 5-point harness.
- 4.1.14 Using the 5-point harness
1. Depress the red button (19) to release the buckle and press the central adjuster (04) to pull out the shoulder straps (05) (Do not pull on the shoulder pads(06)). (fig. 17)
 2. Place your child in the seat.
 3. Ensure that your child's back is lying flat against the backrest of the car seat.

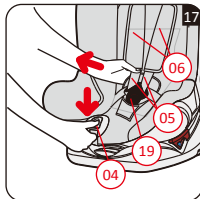
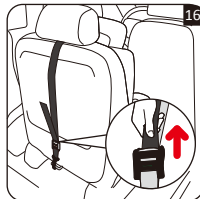

4. Guide the two buckle latches together (20) and insert into the buckle (19) There will be an audible click when the buckle is secured. (fig. 18, 19, 20)

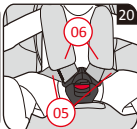
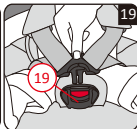
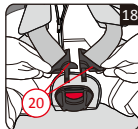

5. Pull outwards on the adjuster strap (21) until the harness is snug against your child's body. Ensure that the harness straps are not twisted at any point. (fig. 21, 22)

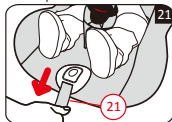

For your child's safety, ensure that the following checks are carried out before every journey:

- The ISOFIX connectors are securely engaged in the anchors and the indicators are both completely green.
- The child seat is placed up against the backrest of the vehicle seat.
- The Top tether strap is tight and the indicator is green.
- The 5-point harness is fitted snugly to the child.
- The shoulder straps are not twisted.
- The shoulder straps sit in the correct position on the child's shoulders.
- The harness buckle is properly secured.

4.2 Group 0+ (0 - 13 KG approx.) with 5-point harness + vehicle belt

- 4.2.1 Ensure that the 5-point harness is correctly installed. (Refer to section 8)
- 4.2.2 Ensure that the 5-point harness is correctly adjusted. (Refer to section 3.2)
- 4.2.3 Adjust the seat to the fullest recline position (See section 3.4) and ensure that the recline mechanism is securely locked.
- 4.2.4 Rotate the seat to the rearward facing position (See section 3.5) and ensure that the rotation mechanism is securely locked.
- 4.2.5 Place the child car seat on the vehicle seat facing the rear of the vehicle (Against the direction of travel). (fig. 23)
- 4.2.6 Pull out the vehicle seat belt as much as possible, and then insert the lap portion of the seatbelt through the belt guides on the base of the seat (22). Fasten the vehicle seat belt buckle (23) and pull to remove any slack from the belt webbing. (fig. 24)

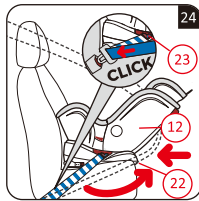

- 4.2.7 Pass the diagonal portion of the vehicle seatbelt through the 2 belt guide rings in the belt lock-off pics (17). (fig. 25)
- 4.2.8 Pull the seat belt webbing upwards as far as possible to remove any slack, ensuring that no part of the vehicle seatbelt is twisted, and close up the belt lock-off. (fig. 26)

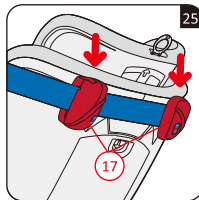

- 4.2.9 Using the 5-point harness
 1. Depress the red button (19) to release the buckle, and press the central adjuster (04) to pull out the shoulder straps (05) (Do not pull on the shoulder pads (06)). (fig. 17)
 2. Place your child in the seat.
 3. Ensure that your child's back is lying flat against the backrest of the seat.
 4. Guide the two buckle latches (20) together and insert into the buckle (19) There will be an audible click when the buckle is secured. (fig. 18, 19, 20)
 5. Pull outwards on the adjustor strap (21) until the harness is snug against your child's body. Ensure that the harness straps are not twisted at any point. (fig. 21, 22)

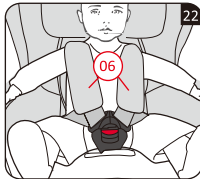
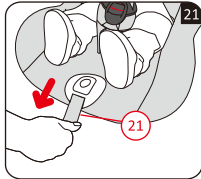
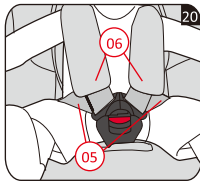
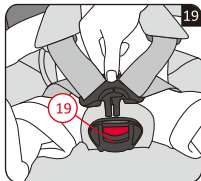
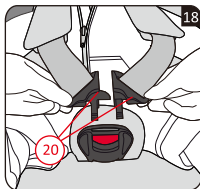
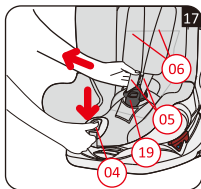

For your child's safety, ensure that the following checks are carried out before every journey:

- The vehicle belt is passed through both of the belt guide rings.
- The vehicle seat belt is taut, remove any slack if necessary and is not twisted.
- The seat is placed up against the back of the vehicle seat, without a gap.
- The 5-point harness is fitted snugly to the child.
- The shoulder straps are not twisted.
- The shoulder straps sit in the correct position on the child's shoulders.
- The harness buckle is properly secured.

5. Forward Facing Installation

5.1 Group I (9 - 18 KG approx.)

5.1.1 With 5-point harness + ISOFIX + Top tether

1. Set up the ISOFIX fittings. (See section 3.1)
2. Ensure that the 5-point harness is correctly installed. (Refer to section 8)
3. Ensure that the 5-point harness is correctly adjusted. (Refer to section 3.2)
4. Adjust the seat to the desired recline position (See section 3.4) and ensure that the recline mechanism is securely locked.
5. Rotate the seat to the forward facing position (See section 3.5) and ensure that the rotation mechanism is securely locked.
6. Place the child car seat on the vehicle seat facing the front of the vehicle (In the direction of travel), (fig. 27)

7. Insert the ISOFIX connectors (15) into the guide socket (02) until an audible click is heard and the indicators (16) are green. (fig. 27, 28)

CAUTION: The ISOFIX connectors (15) are secured only when both indicators (16) are completely green.

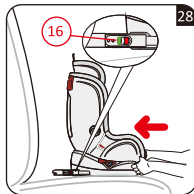
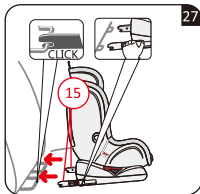

8. Push the seat back until it is flat against the backrest of the vehicle seat, if necessary, remove the vehicle headrest to achieve this. (fig. 29)

9. Depress the release button of the Top tether adjuster to release the strap. (fig. 30)

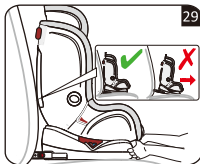

10. Hook the snap hook (18) onto the Top tether anchorage point in your vehicle. To find this, look for this sign (Ⓜ) in your vehicle, or check in your vehicle handbook, or with your vehicle dealer. (fig. 31)

11. Pull on the free end of the Top tether strap tightly until the indicator shows green. (fig. 32)

12. Follow the steps shown in section 4.1.14 to secure your child with the 5-point harness.

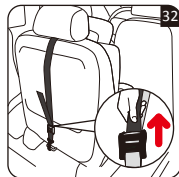
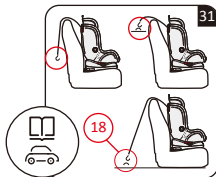

For your child's safety, ensure that the following checks are carried out before every journey:

- The ISOFIX connectors are securely engaged in the anchors and the indicators are both completely green.
- The child seat is sitting flat against the backrest of the vehicle seat.
- The Top tether strap is tight and the indicator is green.
- The 5-point harness is fitted snugly to the child.
- The shoulder straps are not twisted.
- The shoulder straps sit in the correct position on the child's shoulders.
- The harness buckle is properly secured.

5.1.2 With 5-point harness + vehicle belt

1. Ensure that the 5-point harness is correctly installed. (Refer to section 8)
2. Ensure that the 5-point harness is correctly adjusted. (Refer to section 3.2)
3. Adjust the seat to the desired recline position (See section 3.4) and ensure that the recline mechanism is securely locked.
4. Rotate the seat to the forward facing position (See section 3.5) and ensure that the rotation mechanism is securely locked.
5. Place the child car seat on the vehicle seat facing the front of the vehicle (In the direction of travel). (fig. 33)
6. Pull out the vehicle seat belt as much as possible, and then insert the lap portion of the seatbelt through the belt guides on the base of the seat (22). Fasten the vehicle seat belt buckle (23) and pull to remove any slack from the belt webbing. (fig. 34)

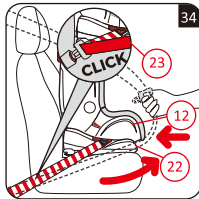

7. Pass the diagonal portion of the vehicle seatbelt through the 2 belt guide rings (17). (fig. 35)
8. Pull the seat belt webbing upwards as far as possible to remove any slack, ensuring that no part of the vehicle seatbelt is twisted, and close up the belt lock-off. (fig. 36)
9. Follow the steps shown in section 4.2.10 to secure your child with the 5-point harness.

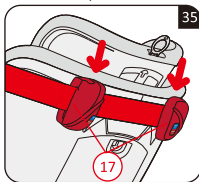

For your child's safety, ensure that the following checks are carried out before every journey:

- The vehicle belt is passed through both of the belt guide rings.
- The vehicle seat belt is taut, remove any slack if necessary and is not twisted.
- The seat is placed up against the back of the vehicle seat, without a gap.
- The 5-point harness is fitted snugly to the child.
- The shoulder straps are not twisted.
- The shoulder straps sit in the correct position on the child's shoulders.
- The harness buckle is properly secured.

5.2 Group II (15 - 25 KG approx.) with 5-point harness + vehicle belt + Top tether

1. Follow the steps shown in section 5.1.2 to install the seat using the vehicle seatbelt.
2. Depress the release button of the Top tether adjuster to release the strap. (fig. 37)
3. Hook the snap hook (18) onto the Top tether anchorage point in your vehicle. To find this, look for this sign in your vehicle, or check in your vehicle handbook, or with your vehicle dealer. (fig. 38)
4. Pull on the free end of the Top tether strap tightly until the indicator shows green. (fig. 39)
5. Follow the steps shown in section 4.2.10 to secure your child with the 5-point harness.

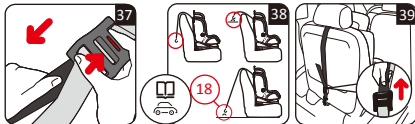

For your child's safety, ensure that the following checks are carried out before every journey:

- The vehicle belt is passed through both of the belt guide rings.
- The vehicle seat belt is taut, remove any slack if necessary and is not twisted.
- The seat is placed up against the back of the vehicle seat, without a gap.
- The Top tether strap is tight and the indicator is green.

- The 5-point harness is fitted snugly to the child.
- The shoulder straps are not twisted.
- The shoulder straps sit in the correct position on the child's shoulders.
- The harness buckle is properly secured.

5.3 Group II & III (15 - 36 KG approx.) with vehicle belt

1. Ensure that the 5-point harness has been removed correctly. (See section 7)
2. Adjust the headrest to the correct position. (See section 3.3)
3. Adjust the seat to the desired recline position (See section 3.4) and ensure that the recline mechanism is securely locked.
4. Rotate the seat to the forward facing position (See section 3.5) and ensure that the rotation mechanism is securely locked.
5. Place the child car seat on the vehicle seat facing the front of the vehicle (In the direction of travel) and place the child in the car seat.
6. Pull out the vehicle seat belt as far as possible and pass it around the front of the child, and secure the buckle (24) (An audible click will be heard). (fig. 40)

CAUTION: Ensure that the seatbelt is not twisted at any point.

7. Pass the diagonal portion of the seatbelt (25) and the lap belt portion (26) on the same side as the vehicle seat buckle(24) under the armrest and through the red belt guide gap (27). (fig. 41)

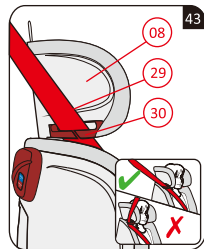
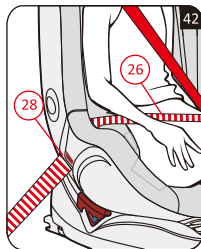
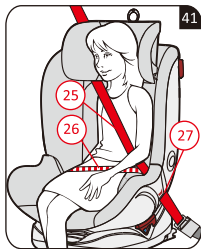
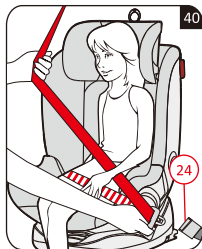

8. Place the lap belt portion of the seatbelt on the opposite side to the vehicle seat buckle through the red belt guide. (28) (fig. 42)
9. Guide the diagonal portion of the vehicle seatbelt (29) through the red belt guide (30) of the headrest (08), ensuring that the vehicle seatbelt is not twisted at any point.
10. Ensure that the diagonal portion of the vehicle seatbelt sits over the child's collar bone and not in front of their neck (fig. 43)

TIP: If necessary, adjust the headrest to ensure that the seatbelt is sitting correctly on the child's shoulder.

For your child's safety, ensure that the following checks are carried out before every journey:

- The diagonal portion of the vehicle belt (25) and the lap belt portion (26) on the side of the vehicle seat buckle (24) is passed through the red belt guide (27).
- The lap belt portion (26) on the opposite side to the vehicle seat buckle is passed through the red belt guide (28).
- The diagonal portion of the vehicle seatbelt (29) is passed through the red belt guide (30) of the headrest (08).
- The diagonal portion of the vehicle seatbelt sits over the child's collar bone and not in front of their neck.
- The vehicle seat belt is tight and not twisted at any point.

6. Removing the APRAMO® ONE™ from the Vehicle

1. Push back both of the ISOFIX release buttons to release the ISOFIX connectors.
2. Undo the vehicle seat belt buckle, and remove the vehicle seatbelt from the belt guide rings (17) and the lower guides (22).
3. Depress the release button of the Top tether strap to release the strap and unhook from the vehicle anchorage point.
4. Push the ISOFIX connectors back into the base of the child car seat.

7. Removing the 5-Point Harness

1. Press down on the central adjuster (04), and pull the shoulder straps towards you (05) (Do not pull on the shoulder pads (06)), extending the 5-point harness as far as it will go. (fig. 44)
2. Pull the adjusting ring (07) upwards, whilst pushing the headrest (08) downwards to its lowest position. (fig. 45)
3. Turn the car seat around so that the rear is facing you.

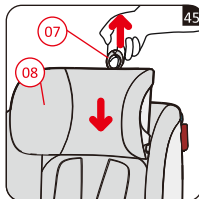
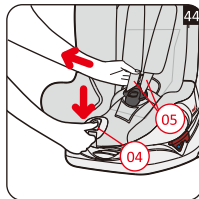

4. Unlatch the rear cover (32) by using the cover latch (31). (fig. 46)
5. Remove the webbing from the joint plate (33). (fig. 47)

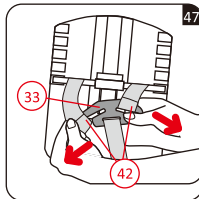
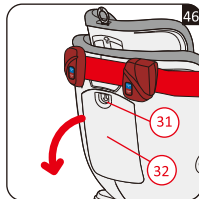

6. Place the joint plate (33) in the recess (34) in the cover. (fig. 48)
7. Remove the loops of the shoulder pads (35) from the headrest lever (36). (fig. 49)
8. Close the rear cover (32).

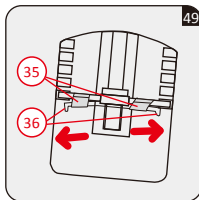
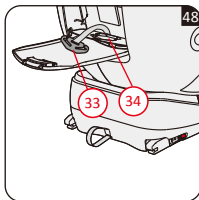

9. Turn the car seat around so that the front is facing you.
10. Pull out the shoulder straps (05) and shoulder pads (06) from the harness slots (37). (fig. 50)
11. Open the buckle (19) of the 5-point harness. (fig. 51)

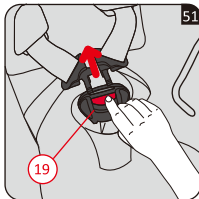
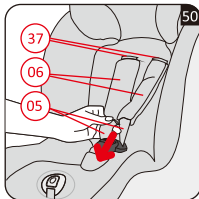

12. Open the cover (39), place the buckle latches in the storage (38) on each side, then replace the cover (39). (fig. 52)
13. Turn the metal plate (40) so that it is vertical, and remove from the housing (41). Remove the 5-point buckle. (fig. 53)

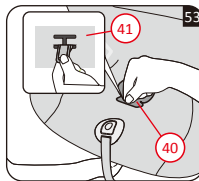
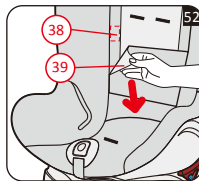

8. Installing the 5-Point Harness

1. Place the buckle (19) into the crotch pad (43). (fig. 54)
2. Turn the metal plate (40) so that it is vertical and insert in the housing (41). Use slot A for Group 0+ & I and slot B for Group II. (fig. 54)
3. Open the cover (39), take the buckle latches out of the storage on each side (38), and then refasten the cover. (fig. 55)

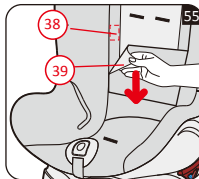
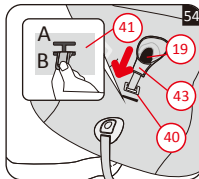

4. Bring the 2 latches of the buckle (44) into the buckle (19).
(fig. 56)

CAUTION: Ensure that the straps are not twisted at any point.

5. Pull the adjusting ring (07) upwards, whilst pushing the headrest (08) downwards to its lowest position. (fig. 57)

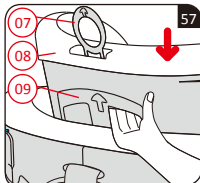
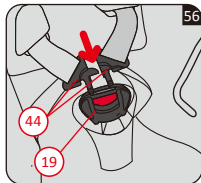

6. Thread both of the shoulder pads (06) onto the shoulder straps (05). (fig. 58)

7. Thread the loops of both the shoulder straps (05) and the shoulder pads (06) through the harness slots (37). The loop of the shoulder pad should be beneath the loop of the shoulder strap. (fig. 59)

Turn the car seat around so that the rear is facing you.

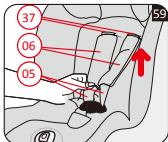
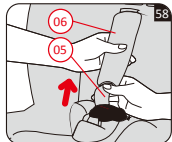

8. Unlatch the rear cover (32) by using the cover latch (31).
(fig. 60)

9. Fix the loops of the shoulder pads (35) on the headrest lever (36). (fig. 61)

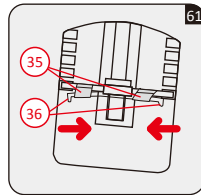
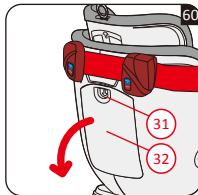

10. Remove the joint plate (33) from the recess (34) in the cover. (fig. 62)

11. Place the webbing loops of the shoulder straps (42) over the joint plate (33). (fig. 63)

CAUTION: Ensure that the straps are not twisted at any point.

12. Close the rear cover (32).

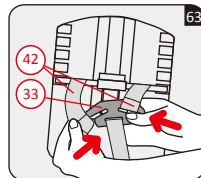
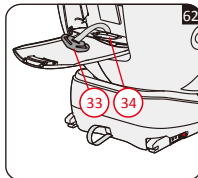

9. Care and Maintenance

9.1 Harness buckle maintenance

Buckle failure can cause injury; do not use any oil or other lubricants on any part of the buckle. Buckle malfunctions are usually caused by a build-up of debris such as food crumbs or other small particles.

Signs of buckle malfunction:

- The buckle latches are slow to release when the red release button is depressed.
- The buckle latches will not lock into the buckle securely.
- The buckle latches engage without an audible click.
- The buckle latches are difficult to insert (Any resistance is felt).
- The buckle opens only when extreme force is applied.

To clean the harness buckle

1. Follow steps shown in section 7 to remove the buckle from the seat. (figs. 51, 53)
2. Soak the harness buckle in warm water with mild washing up liquid only for at least an hour. Rinse and allow to air dry thoroughly before replacing the buckle on the seat. (fig. 64)

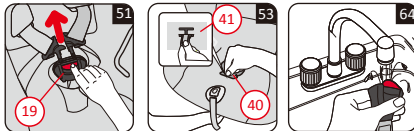

9.2 Cleaning the car seat covers

The seat covers are removable and washable, please refer to the fabric care label on the seat cover for full instructions.

To remove the seat covers

1. Adjust the headrest to the highest position. (fig. 65)
2. Remove the cover of the headrest first.
3. Remove the remaining seat covers.

To refit the seat covers

1. Repeat the above steps in reverse order.
2. To fit and tidy up the seat cover with fabric tidier(45), ensure all covers and trim are replaced correctly. (fig. 66)

9.3 Internal cushion of seat cover

1. Semicircle foam cushion (46) and internal cushion (47) of seat cover are suitable for the rearward facing.
2. Internal cushion (47) of seat cover is suitable for Group I of forward facing. (fig. 67)

CAUTION: Never use the child car seat without the covers supplied, always ensure that the covers and harness straps are correctly installed. In case of doubt, please contact our Customer Service Department.

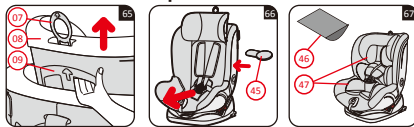

10. Applicable Car List

10.1 The category of child car seat

The APRAMO® ONE™ seat is classified for "Universal" and "Semi-universal" use, the suitable fitting methods as below:

GROUP	GROUP 0+ 0 - 13KG (APPR 0 - 18M)		GROUP I 9 - 18KG (APPR 9M - 4Y)	GROUP II 15 - 25KG (APPR 3 - 6Y)	GROUP II & III 15 - 36KG (APPR 3 - 12Y)
	Semi-Universal	Universal	Universal	Semi-Universal	Universal
Rearward facing	✓	✓			
Forward facing			✓	✓	✓
3-Point vehicle belt with retractor		✓	✓	✓	✓
ISOFIX	✓		✓		
Top tether	✓		✓	✓	
5-Point safety harness	✓	✓	✓	✓	
Adjustable headrest	✓	✓	✓	✓	✓
Adjustable recline			✓	✓	✓

10.2 As a "Universal" child car seat

It will fit most, but not all car seat positions for general use in vehicles that the vehicle is capable of accepting a "Universal" child car seat for this age Group in the vehicle handbook.

10.3 As a "Semi-universal" child car seat

It is suitable for fixing into the seat positions of the following cars:

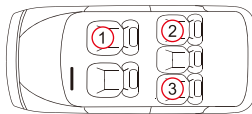

Car Manufacture Model

Alfa Romeo



Giulietta (2010>)
Mito (2009>)

Audi

A1 (2011>)
A1 Sportback (2012>)
A4 Allroad (2009>)
A4 Avant (2008>)
A4 S4 (2009>)
A5 (2007>)
A5 Sportback (2009>)
A6 (2011>)
A6 Allroad (2011>)
A6 Avant (2011>)
A6 S6 (2011>)
A7 Sportback (2011>)
A8 (2011>)
A8 S8 (2011>)
Q3 (2013>)
Q5 (2009>)
Q7 (2006>)

Bentley

Continental GT (2003-2011)
Continental GTC (2005-2012)
Mulsanne (2010>)

	 ISOFIX			 3-Point Vehicle Belt		
	1	2	3	1	2	3
Alfa Romeo Giulietta (2010>)	○	○	○	○	●	●
Alfa Romeo Mito (2009>)	○	●	●	○	●	●
Audi A1 (2011>)	○	●	●	○	●	●
Audi A1 Sportback (2012>)	○	●	●	○	●	●
Audi A4 Allroad (2009>)	○	●	●	○	●	●
Audi A4 Avant (2008>)	○	●	●	○	●	●
Audi A4 S4 (2009>)	○	●	●	○	●	●
Audi A5 (2007>)	○	●	●	○	●	●
Audi A5 Sportback (2009>)	○	●	●	○	●	●
Audi A6 (2011>)	○	●	●	○	●	●
Audi A6 Allroad (2011>)	○	●	●	○	●	●
Audi A6 Avant (2011>)	○	●	●	○	●	●
Audi A6 S6 (2011>)	○	●	●	○	●	●
Audi A7 Sportback (2011>)	○	●	●	○	●	●
Audi A8 (2011>)	○	●	●	○	●	●
Audi A8 S8 (2011>)	○	●	●	○	●	●
Audi Q3 (2013>)	○	●	●	○	●	●
Audi Q5 (2009>)	○	●	●	○	●	●
Audi Q7 (2006>)	○	●	●	○	●	●
Bentley Continental GT (2003-2011)	○	●	●	○	●	●
Bentley Continental GTC (2005-2012)	○	●	●	○	●	●
Bentley Mulsanne (2010>)	○	●	●	○	●	●

Car Manufacture	Model	ISOFIX			3-Point Vehicle Belt		
		1	2	3	1	2	3
BMW	1 Series Convertible (2008>)	○	●	●	○	●	●
	1 Series Coupe (2008>)	○	●	●	○	●	●
	3 Series Coupe (2007>)	○	●	●	○	●	●
	5 Series (2011>)	○	●	●	○	●	●
	6 Series Coupe (2011>)	○	●	●	○	●	●
	7 Series (2010>)	○	●	●	○	●	●
	X3 F25 (2011>)	○	●	●	○	●	●
	X5 (2007>)	○	●	●	○	●	●
	X6 (2008>)	○	●	●	○	●	●
	5-GT (2010>)	○	●	●	○	●	●
Cadillac	BLS Saloon (2006-2011)	○	●	●	○	●	●
Chevrolet	Aveo 3dr (2012>)	○	●	●	○	●	●
	Aveo 5dr (2012>)	○	●	●	○	●	●
	Captiva (2007>)	○	●	●	○	●	●
	Cruze (2009>)	○	●	●	○	●	●
	Spark (2009>)	○	●	●	○	●	●
	Volt (2008>)	○	●	●	○	●	●
Chrysler	A4 S4 (2011>)	○	●	●	○	●	●
	Grand Voyager (2008>)	○	●	●	○	●	●
	Ypsilon (2011>)	○	●	●	○	●	●
Fiat	300 C (2012>)	○	●	●	○	●	●
	500 C (2009>)	○	●	●	○	●	●
	500 L (2013>)	○	●	●	○	●	●
Abarth	Panda (2012>)	○	●	●	○	●	●
	Grande Punto (2008-2011)	○	●	●	○	●	●

Car Manufacture	Model	ISOFIX			3-Point Vehicle Belt		
		1	2	3	1	2	3
Ford	B Max (2012>)	○	●	●	○	●	●
	Fiesta (2008>)	○	●	●	○	●	●
	Focus (2010>)	○	●	●	○	●	●
	KA (2009>)	○	●	●	○	●	●
	Kuga (2013>)	○	●	●	○	●	●
Mercedec Benz	A Class (2013>)	○	●	●	○	●	●
	B Class (2012>)	○	●	●	○	●	●
	C Class (2008>)	○	●	●	○	●	●
	CLA (2013>)	○	●	●	○	●	●
	E Class (2009>)	○	●	●	○	●	●
	GL Class (2006-2012)	○	●	●	○	●	●
	R Class (2006-2012)	○	●	●	○	●	●
Nissan	S Class (2006-2013)	○	●	●	○	●	●
	Juke (2010>)	○	●	●	○	●	●
Volvo	X-Trail (2007>)	○	●	●	○	●	●
	C30 (2007-2012)	○	●	●	○	●	●
	S80 (2007>)	○	●	●	○	●	●
	V40 (2012>)	○	●	●	○	●	●
	V60 (2011>)	○	○	○	○	●	●
	V70 (2008>)	○	●	●	○	●	●
	XC70 (2008>)	○	●	●	○	●	●

REMARKS: ● Applicable ○ Not Applicable

Notice:

Seat positions in other cars may also be suitable to accept this child car seat. If in doubt, consult either our Customer Services Department or the retailers.

WE START WITH SAFETY

APRAMO UK LTD

UNITS 46-48,
DRAYTON MANOR BUSINESS PARK,
COLESHILL ROAD, TAMWORTH
B78 3GL

www.apramo.com

